

ORDINANCE NO. 1 - 1966

AN ORDINANCE PROVIDING FOR THE ANNEXATION TO THE TOWN OF HARRAH, OKLAHOMA, OF THE LAND HEREIN DESCRIBED AND EXTENDING THE BOUNDARIES TO INCLUDE SAID LAND: MAKING JURISDICTIONAL FINDINGS OF FACT, PROVIDING THAT IF ANY PART OR PARTS HEREOF BE HELD INVALID OR INEFFECTIVE THE REMAINING PORTIONS SHALL NOT BE AFFECTED AND DECLARING AN EMERGENCY.

(EMERGENCY ORDINANCE)

BE IT ORDAINED BY THE BOARD OF TRUSTEES OF THE TOWN OF HARRAH, OKLAHOMA:

Section 1. That whereas, consent in writing and petitions for annexation of land having been presented to the Board of Trustees of the Town of Harrah, Oklahoma, by more than three fourths (3/4ths) of the owners in value of all land territory herein described and signed by more than three fourths (3/4ths) of the legally qualified voters living thereon, requesting the annexation to the Town of Harrah, Oklahoma, of all the following land and territory situated in Oklahoma County, State of Oklahoma, to-wit:

All of sections one (1), two (2), three (3), four (4), five (5), eight (8), nine (9), ten (10), eleven (11), twelve (12), thirteen (13), sixteen (16), seventeen (17), twenty-four (24), twenty-five (25), and thirty-six (36), in Township Twelve (12) North, Range One (1), East of the I.M. Oklahoma County, Oklahoma.

1, 2, 3, 4, 5, 8, 9, 10, 11, 12, 13, 16, 17, 24, 25, 36
12-18

All of sections one (1), two (2), three (3), four (4), five (5), eight (8), nine (9), ten (10), eleven (11), twelve (12), and the East One-half (E 1/2) of section fifteen (15), Township Eleven (11) North, Range One (1) East of the I.M. Oklahoma County, Oklahoma.

1, 2, 3, 4, 5, 8, 10, 11, 12, 15, 11-18

All of the South one-half (1/2) of section twenty-three (23), North of the north right of way line of the Chicago, Rock Island, and Pacific Railroads and the Northeast Quarter (NE 1/4) of the Northeast Quarter (NE 1/4) of Section twenty-three (23) Township Twelve (12) North, Range One (1) East of the I.M. Oklahoma County, Oklahoma.

23-12-18

All of the South One-half ($S\frac{1}{2}$) of the North One-half ($N\frac{1}{2}$) of Sections thirty-two (32), thirty-three (33), thirty-four (34), thirty-five (35), and the Southeast Quarter ($SE\frac{1}{4}$) of Section thirty-two (32), and the South One-half ($S\frac{1}{2}$) of Sections thirty-three (33), thirty-four (34), thirty-five (35) all in Township Twelve (12) North, Range One (1) East of the I.M. Oklahoma County, Oklahoma. ✓ 12-1E

The North One-half ($N\frac{1}{2}$) of the Southeast Quarter ($SE\frac{1}{4}$) of the Northwest Quarter ($NW\frac{1}{4}$) of Section Fourteen (14), Township Twelve (12), North, Range One (1) East of the I.M. in Oklahoma County, Oklahoma. ✓ 14-12-1E

All of Sections Twenty (20) and twenty-one (21), North of the north right of way line of the Chicago, Rock Island, and Pacific Railroad Township Twelve (12) North, Range One (1) East of the I.M. Oklahoma County, Oklahoma. ✓ 20-21-12-1E

The North One-half ($N\frac{1}{2}$) of the Southwest Quarter ($SW\frac{1}{4}$) of the Northwest Quarter ($NW\frac{1}{4}$) and all of the North One-half ($N\frac{1}{2}$) of the Northwest Quarter ($NW\frac{1}{4}$) of Section Fourteen (14), Township Twelve (12) North, Range One (1) East of the I.M. in Oklahoma County, Oklahoma. ✓ 14-12-1E

All of the Northeast Quarter ($NE\frac{1}{4}$) and the East One-half ($E\frac{1}{2}$) of the Southeast Quarter ($SE\frac{1}{4}$) of Section Fourteen (14) Township Twelve (12) North, Range One (1) East of the I.M. Oklahoma County, Oklahoma. ✓ 14-12-1E

All of the West One-half ($W\frac{1}{2}$) of Section Fifteen (15), and the North One-half ($N\frac{1}{2}$) of the Northeast Quarter ($NE\frac{1}{4}$) of Section Fifteen (15), Township Twelve (12) North, Range One (1) East of the I.M. Oklahoma County, Oklahoma. ✓ 15-12-1E

All of the West One-half ($W\frac{1}{2}$) of Section Twenty-two (22), and the Northwest Quarter ($NW\frac{1}{4}$) of the Southeast Quarter ($SE\frac{1}{4}$) of Section Twenty-two (22), Township Twelve (12) North, Range One (1) East of the I.M. Oklahoma County, Oklahoma. ✓ 22-12-1E

Section 2. That said land is contiguous to the Town of Harrah, Oklahoma. That the Corporate limits of the

Town of Harrah, Oklahoma be and they are extended to include all of the above land and territory, A copy of this ordinance, duly certified by the President of the Board of Trustees of the Town of Harrah, Oklahoma, shall be filed in the office of the County Clerk of Oklahoma County, State of Oklahoma together with an accurate map of the territory annexed.

Section 3. That if any part hereof be invalid or ineffective the remaining portion of this ordinance shall not be ~~effective~~ affected.

Section 4. All ordinances or parts of ordinances in conflict herewith are hereby repealed.

Section 5. (Emergency) WHEREAS, it being immediately necessary for the preservation of peace, health, and safety of the Town of Harrah, Oklahoma, and the inhabitants thereof, the provisions of this ordinance be put in full force, and effect and an emergency is hereby declared to exist by reason thereof this ordinance shall take effect and be in full force and effect from and after passage provided by law.

Passed and Approved and the emergency clause voted upon separately and passed and approved this 7th day of April, 1966.

Signed by the Board of Trustees this 7th day of April, 1966.

A. E. Gunn
PRESIDENT,
BOARD OF TRUSTEES

Leon Israel
MEMBER,
BOARD OF TRUSTEES

James A. Cook
MEMBER,
BOARD OF TRUSTEES

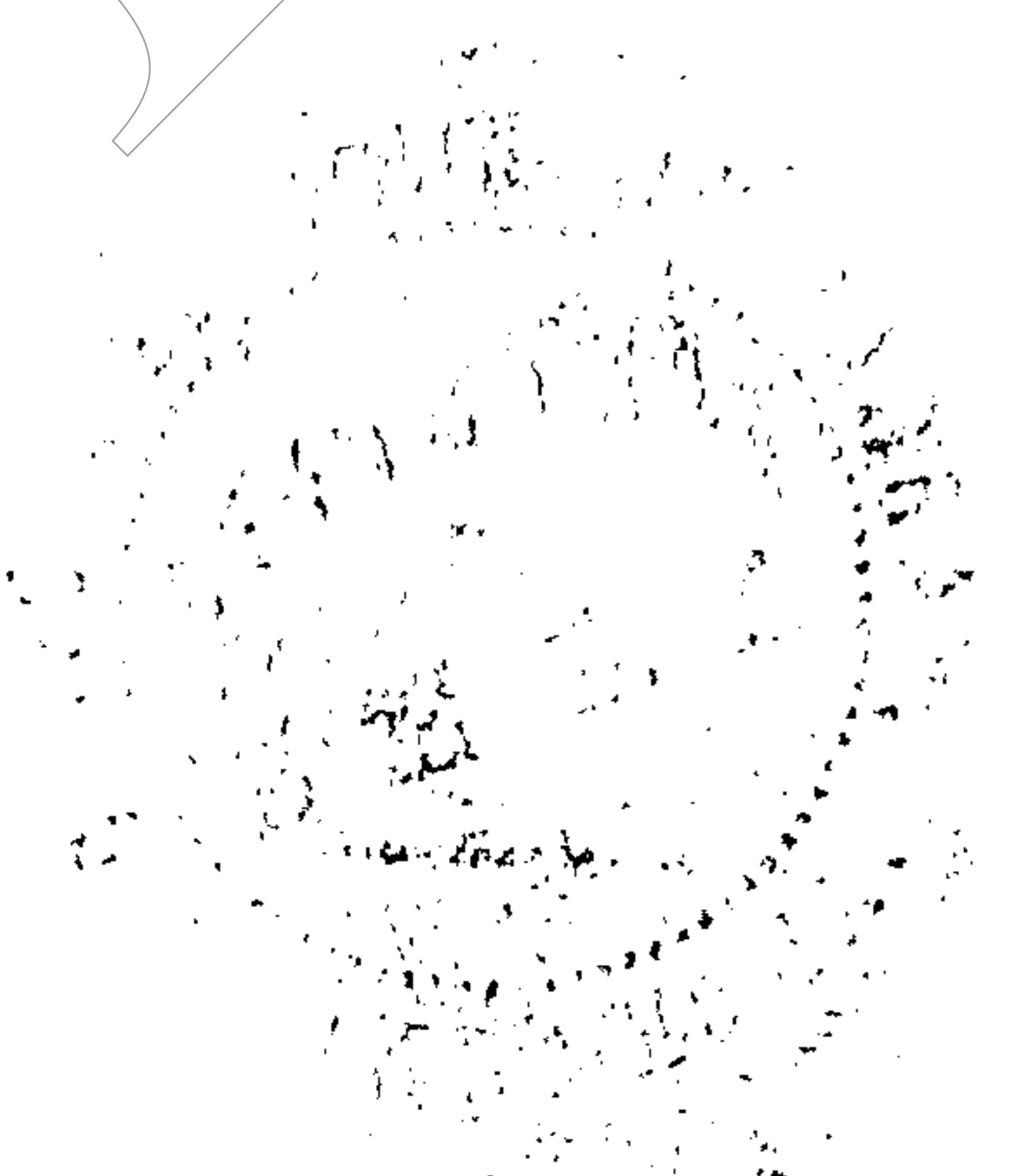

(SEAL)

Attest:

James A. Cook
TOWN CLERK

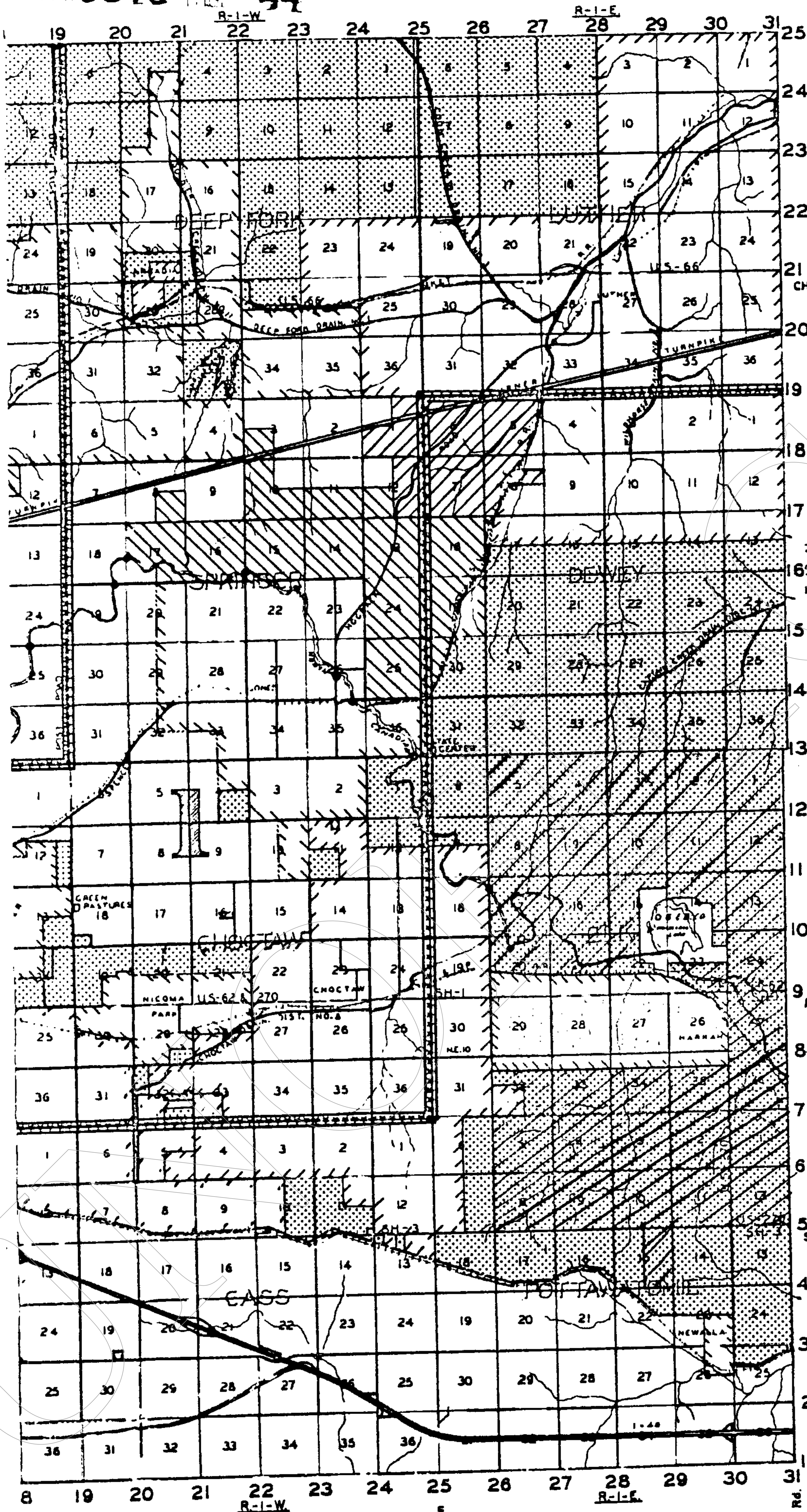

THE HIGHWAY SYSTEM OF OKLAHOMA COUNTY, OKLA. 1964



SCALE
1 INCH = 4000 FT.

- LEGEND**
- COMM. DIST. LINES
 - OKLAHOMA CITY LIMITS
 - U.S. & STATE HIGHWAYS
 - COUNTY HIGHWAYS PAVED
 - COUNTY HIGHWAYS GRAVELED
 - RIVER BRIDGE
 - SCHOOL
 - EXPRESSWAYS OR FOUR LANE ROUTES
 - PROPOSED ROUTES
 - PROJECTS UNDER CONSTR.
 - PROJECTS COMPLETED
 - COUNTY
 - MUNICIPAL BOUNDARIES
 - DISPUTED

J. L. Klappier
DRAWN BY

Annexed

Revised JAN. 1965

19 20 21 22 23 24 25 26 27 28 29 30 31
R-I-W R-I-E
18 19 20 21 22 23 24 25 26 27 28 29 30 31
R-I-W R-I-E
C O U N T Y
Pocahontas Rd. Peabody Luther Dobbs Harrah

P O T T A W A T O M I E C O U N T Y

C O U N T Y
Anderson Hennessy Choctaw Indian Meridian Triple XXX Peabody Luther Dobbs Harrah

Proof of Publication

County of ~~Harrah~~ Oklahoma

TOWNSHIP OF HARRAH, OKLAHOMA

Affidavit of Publication

ORDINANCE #1 EMERGENCY

James W. Hall, of lawful age, being duly sworn, upon oath deposes and says that he is the publisher of the HARRAH NEWS, a weekly newspaper printed in Harrah, Oklahoma County, Oklahoma, and of a bonafide paid general circulation therein, printed in the English language, and entered into the United States mail as second class mail matter; and published in the county where delivered into United States mail, and that the notice by publication, a copy of which is hereto attached was published in said newspaper for 1 consecutive weeks, the first publication being on the 14 day of APRIL, 1966, and the last day of publication being on the 14 day of APRIL, 1966, and that said newspaper has been continuously and uninterruptedly published in said county during the period of One Hundred and Four (104) weeks consecutively, prior to the first publication of said notice or advertisement as required by House Bill 27, (an Act amending Section 54, Oklahoma Statutes, 1931), passed by the Eighteenth Legislature. Said newspaper comes within all of the prescriptions and requirements of said act.

The advertisement above referred to, a true and printed copy of which is hereto attached, was published in said HARRAH NEWS on the following dates, to-wit;

Table with 3 columns: Insertion number, Date, and Page number. 1st Insertion 14 APRIL 1966 4th Insertion 19; 2nd Insertion 19 5th Insertion 19; 3rd Insertion 19 6th Insertion 19

Said notice was published in the regular edition of said newspaper and not in a supplement thereto.

Publishing Fee \$26.79

Subscribed and sworn to before me this 14th day of April, 1966

Signed

My Commission Expires Feb 10, 1967

BOOK 3346 PAGE 45

Mr. and Mrs. Jack Scivally visited Sunday evening with Mr. and Mrs. Tony Fortelney and family.

Fourteen (14), Township Twelve (12) North, Range One (1) East of the I.M. in Oklahoma County, Oklahoma. All of Sections Twenty (20) and twenty-one (21), North of the north right of way line of the Chicago, Northwest Quarter (NW1/4) of Section Rock Island, and Pacific Railroad Township Twelve (12) North, Range One (1) East of the I.M. Oklahoma County, Oklahoma. The North One-half (NW1/4) of the Southwest Quarter (SW1/4) and all of the North One-half (NW1/4) of the Northwest Quarter (NW1/4) of Section Fourteen (14), Township Twelve (12) North, Range One (1) East of the I.M. in Oklahoma County, Oklahoma.

All of the Northeast Quarter (NE1/4) and the East One-half (E1/2) of the Southeast Quarter (SE1/4) of Section Fourteen (14), Township Twelve (12) North, Range One (1) East of the I.M. Oklahoma County, Oklahoma. All of the West One-half (W1/2) of Section Fifteen (15), and the North One-half (NW1/4) of the Northeast Quarter (NE1/4) of Section Fifteen (15), Township Twelve (12) North, Range One (1) East of the I.M. Oklahoma County, Oklahoma.

All of the West One-half (W1/2) of Section Fifteen (15), and the North One-half (NW1/4) of the Northeast Quarter (NE1/4) of Section Fifteen (15), Township Twelve (12) North, Range One (1) East of the I.M. Oklahoma County, Oklahoma. All of the West One-half (W1/2) of Section Twenty-two (22), and the Northeast Quarter (NE1/4) of the Southwest Quarter (SW1/4) of Section Twenty-two (22), Township Twelve (12) North, Range One (1) East of the I.M. Oklahoma County, Oklahoma.

Section 2. That said land is contiguous to the Town of Harrah, Oklahoma. That the Corporate limits of the Town of Harrah, Oklahoma, be and they are extended to include all of the above land and territory. A copy of this ordinance, duly certified by the President of the Board of Trustees of the Town of Harrah, Oklahoma, shall be filed in the office of the County Clerk of Oklahoma County, State of Oklahoma together with an accurate map of the territory annexed.

Section 3. That if any part hereof be invalid or ineffective the remaining portion of this ordinance shall not be affected.

Section 4. All ordinances or parts of ordinances in conflict herewith are hereby repealed.

Section 5. (Emergency) WHEREAS, it being immediately necessary for the preservation of peace, health, and safety of the Town of Harrah, Oklahoma, and the inhabitants thereof, the provisions of this ordinance be put in full force, and effect and an emergency is hereby declared to exist by reason thereof this ordinance shall take effect and be in full force and effect from and after passage provided by law.

Passed and Approved and the emergency clause voted upon separately and passed and approved this 7th day of April, 1966.

Signed by the Board of Trustees this 7th day of April, 1966.

H. E. OZMUN, President Board of Trustees. LEON HENSEL, Member, Board of Trustees. JAMES H. COOK, Member, Board of Trustees.

Attest: J. C. MAPLES, Town Clerk (SEAL)

LEGAL NOTICE

Published in The Harrah News April 14, 1966

ORDINANCE NO. 1 - 1966 AN ORDINANCE PROVIDING FOR THE ANNEXATION TO THE TOWN OF HARRAH, OKLAHOMA, OF THE LAND HEREIN DESCRIBED AND EXTENDING THE BOUNDARIES TO INCLUDE SAID LAND. MAKING JURISDICTIONAL FINDINGS OF FACT, PROVIDING THAT IF HELD INVALID OR INEFFECTIVE THE REMAINING PORTIONS SHALL NOT BE AFFECTED AND DECLARING AN EMERGENCY.

(EMERGENCY ORDINANCE) BE IT ORDAINED BY THE BOARD OF TRUSTEES OF THE TOWN OF HARRAH, OKLAHOMA: Section 1. That whereas, consent in writing and petitions for annexation to the land having been presented to the Board of Trustees of the Town of Harrah, Oklahoma, by more than three fourths (3/4) of the owners in value of all land territory herein described and signed by more than three-fourths (3/4) of the legally qualified voters living thereon, requesting the annexation to the Town of Harrah, Oklahoma, of all the following land and territory situated in Oklahoma County, State of Oklahoma, to-wit:

All of sections one (1), two (2), three (3), four (4), five (5), eight (8), nine (9), ten (10), eleven (11), twelve (12), thirteen (13), sixteen (16), seventeen (17), twenty-four (24), twenty-five (25), and thirty-six (36) in Township Twelve (12) North, Range One (1), East of the I.M. Oklahoma County, Oklahoma. All of sections one (1), two (2), three (3), four (4), five (5), eight (8), nine (9), ten (10), eleven (11) of section fifteen (15), Township Eleven (11) North, Range One (1), East of the I.M. Oklahoma County, Oklahoma.

All of the South one-half (1/2) of section twenty-three (23), North of the north right of way line of the Chicago, Rock Island, and Pacific Railroads and the Northeast Quarter (NE1/4) of the Northeast Quarter (NE1/4) of Section twenty-three (23), Township Twelve (12) North, Range One (1) East of the I.M. Oklahoma County, Oklahoma.

All of the South One-half (S1/2) of Sections thirty-two (32), thirty-three (33), thirty-four (34), thirty-five (35), and the Southeast Quarter (SE1/4) of Section thirty-two (32), and the South One-half (S1/2) of Sections thirty-three (33), thirty-four (34), thirty-five (35), all in Township Twelve (12) North, Range One (1) East of the I.M. Oklahoma County, Oklahoma. The North One-half (N1/4) of the Southeast Quarter (SE1/4) of the

IF YOU OWN SOMETHING YOU WANT TO SELL. Write full description, location and Price to us. We buy acres, mortgages, houses, guns, stocks, cut glass all for cash if it is a bargain. CASH, P.O. Box 166, Okla. City

STATE OF OKLAHOMA, OKLAHOMA COUNTY, SS: THIS INSTRUMENT WAS FILED FOR RECORD ON PAGE 4 THE 22 DAY OF April, 1966, AT 3:43 O'CLOCK P.M. AND DULY RECORDED. JOE MATTOX, COUNTY CLERK FEE 740 BY Gale DEPUTY.